

Spacial 3D steel enclosure

Universal enclosure	2
Spacial 3D steel enclosure applications	4
Spacial 3D steel enclosure accessories	12
Configured enclosure	58
Terminals enclosures	62
Screw fixed cover enclosure	68
ATEX Spacial 3D enclosure	72
Modular distribution enclosure	78
19" Spacial 3D enclosure	84
Universal enclosure	87
EMC Spacial 3D enclosure	92
Control and human-machine dialogue enclosure	94
Specific enclosure	108

Spacial 3D steel enclosure application selection guide

Spacial 3D universal enclosures

- A complete offer of 54 dimensions:
 - with plain door, without plain chassis,
 - with plain door and plain chassis,
 - with glazed door, without plain mounting plate.
- Robustness with a new look.
- Degree of protection IP 66 (IP 55 for 2-door enclosures).
- Conformity standard EN 62208.
- Customised enclosures available.

page 4



- An offer developed for centralisation and transmission of signals in industrial installations or on machines.
- Offer of 150 mm depth enclosures, equipped with a scale mounting plate and symmetrical DIN rail, not assembled.
- Main advantages:
 - degree of protection IP 66,
 - door with hinges enabling 180° door opening,
 - many accessories.
- Pre-mounted earthing leads on body.

page 62

Terminals enclosure



- A complete range of enclosures equipped with modular chassis, comprising 10 references from 24 to 240 modules.
- An offer supplemented by a range of modular chassis and accessories: front plates, plain chassis and blanking covers.
- Main advantages:
 - adjustable rail depth,
 - quick fixing with clip-on cover plates,
 - IP 66, IP 55 (double door) watertightness,
 - many accessories.
- Earthing connection mounted.

page 78

Modular distribution enclosure



- A modular system comprising:
 - 8 control enclosures,
 - 1 keyboard enclosure,
 - 1 system of arms with fixed or rotating joints,
 - support and lighting accessories.
- A rugged, ergonomic and attractive solution simply adapted to each application.
- Customised on request (colour).
- Other advantages:
 - degree of protection IP 55,
 - ease of wiring and maintenance.

page 94

Control and dialogue system



- A complete offer comprising:
 - 5 enclosures, fixed rack 5 to 17 U,
 - 5 enclosures, swing rack 4 to 16 U,
 - 5 2-body enclosures, depth 400 mm,
 - 5 2-body enclosures, depth 500 mm.
- The offer is completed with a range of fixed and pivoting 19" mounting plates.
- Main advantages:
 - degree of protection IP 66,
 - glazed door,
 - many accessories.
- Earthing connection mounted.

19" network and electronics enclosure



page 3/149

- Time-saving.
- You can focus on wiring since SAREL has taken care of the cut-outs and accessory mounting.
- Easy.
A single purchase order and a single delivery. SAREL optimises your management and goods reception.
- Cut-outs quality.
Painting after execution of cut-outs means improved corrosion resistance.

A customised enclosure with the Configured and Specific solution



page 1/114

And also...

EMC enclosure



page 92

Stainless steel enclosure



page 1/434

ATEX enclosure



page 72

THALASSA polyester enclosure



page 1/494

Configured



page 60

Specific



page 61

Spacial 3D: your ideal universal enclosure!

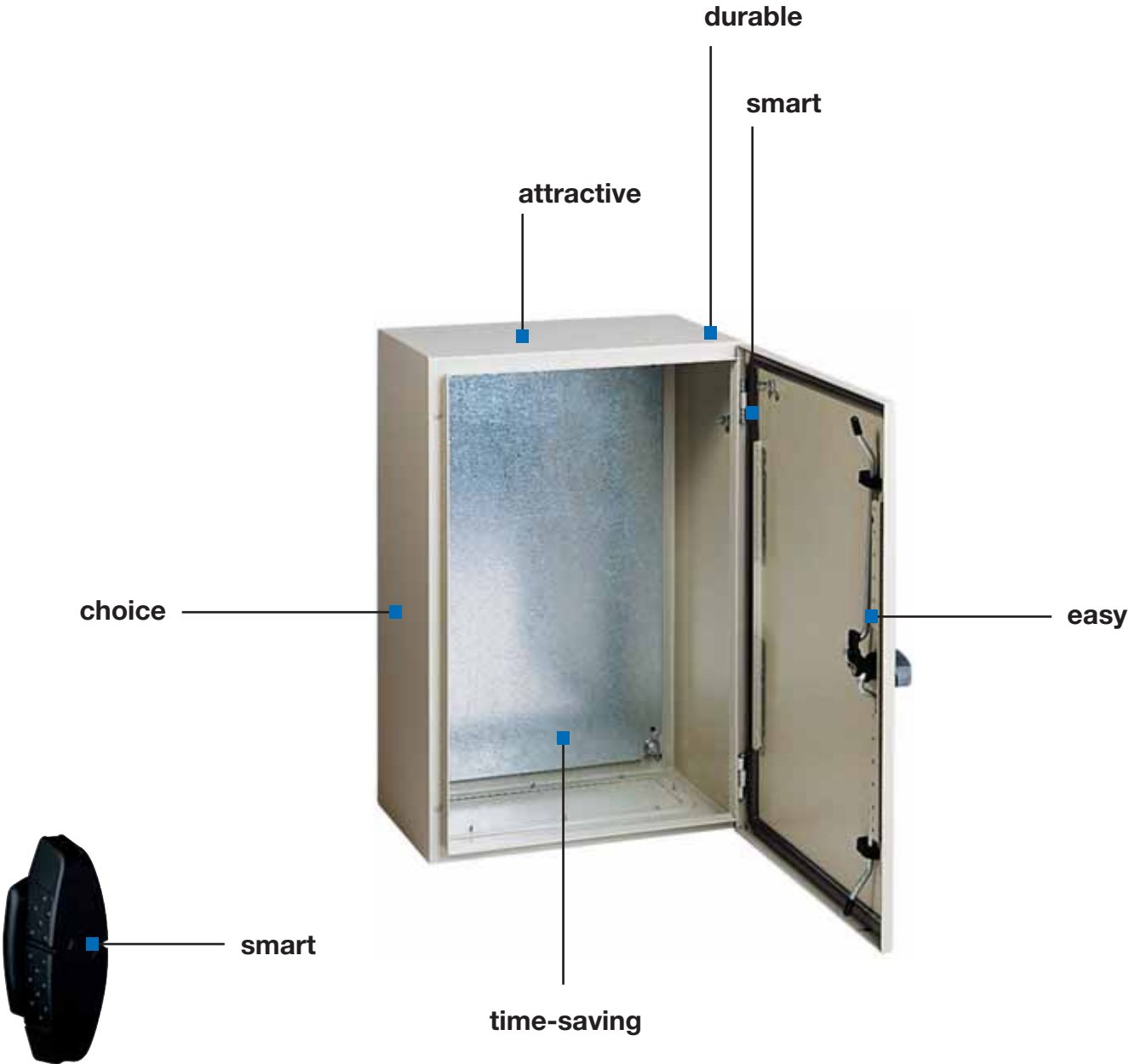

■ attractive

Chamfered door edge, plasma welded, polyester paint.

■ choice

Plain door: 54 references.
With plain chassis: 54 references.
With glazed door: 44 references.
Plain chassis.
Silkscreened chassis.
Microperforated chassis.
Telequick perforated chassis.
Symmetrical chassis.
Steel cable gland plate with markings.
Steel cable gland plate with knock-outs.
Aluminium cable gland plate.
Cable gland plate with membranes.

■ smart

Operating handle delivered with the enclosure. It can be connected to the locking system with a safety piece. It also enables loosening the caps that protect the supporting pins of the paint.
Hinges easily released and captive.

■ time saving

Configured offer: alternative colours, accessories mounted, machining undertaken, other dimensions.

■ durable

Polyester paint and good UV resistance. Treated hinges, aluminium pins.

■ easy

Door removal, door reversal, choice of inserts.

and also...

■ strong

IK10, body gutter with double fold, vertically chamfered door with double fold, 50 kg/m² load on the door.

■ watertight

IP 66, polyurethane seal and double fold door.
3 closure points from height 600 mm.

■ light and resistant

Folded cross structure sheet steel enclosure, corrosion resistant: plasma welded and polyester paint finish.

■ practical

Wide range of accessories, reusable packaging.

■ customised

For other machining, colours, locks, etc., SAREL offers you a customised service, with a Configured solution (see page **60**) or a Specific solution (see page **108**).

Universal enclosure

Technical characteristics

- Three enclosure versions are available:
 - with plain door,
 - plain door enclosure delivered with a galvanised mounting plate, not assembled.
 - with glazed door, Securit glass thickness 4 mm.
- Textured polyester powder paint finish, colour grey RAL 7032.
- IP 66 protection for single door enclosures and IP 55 for double door enclosures conforming to NF EN 60529.
- Nema Type 4.4X for single door enclosure and Nema Type 12, 12K, 13 for double door enclosure conforming to UL 508A.
- External mechanical impact resistance:
 - IK10 for plain door enclosures, conforming to EN 62262,
 - IK 08 for enclosures with glazed door.
- One-piece folded and welded body, double plate thickness gutter shaped front profile. Flat rear panel.
- Perforated rails on door, drilled diameter 4.2 on 25 mm pitch:
 - 2 vertical rails from height 400 mm,
 - 2 vertical rails and 2 horizontal rails from width 800 mm.
- Door easily removable and reversible with double thickness 20 mm return fold for excellent rigidity, 120° opening, 2 or 3 concealed hinges*. Three locking points from height 600 mm with rod linkage mechanism, with single operating point. Simple reversal of linkage. Maximum loading: 50 kg/m².
- Enclosure supplied as standard with 3 mm double bar lock. The handle supplied has two functions:
 - as operating key,
 - as tool for removal of stud protective caps.
- Polyurethane door seal.
- M6 × 16 earthing screw for equipotential connection between enclosure door and body.
- Direct wall mounting direct (4 holes Ø 10) or using fixing lugs (to be ordered separately, see page 13).
- 4 (or 6**) shouldered backstuds M8 × 25 for mounting of chassis and step slides, leaving 10 mm clearance from rear panel.
- Cable gland plate with markings, which facilitates perforation and ensures an optimum access surface. Delivered with the enclosure.

Certifications

- Conforms to enclosure standards EN 62208 (LCIE), UL, CUL, BV, DNV, LR, GL, ATEX.

Special versions

- These enclosures can be supplied on request with:
 - alternative colours,
 - accessories premounted,
 - special machining,
 - other dimensions,
 - alternative finishes (zinc chromate, metallisation, etc.),
 - etc.
- See our customised service page 58.



Enclosure with single door



Enclosure with double door



Enclosure with plain galvanised chassis



Double bar lock

* From height 800 mm.

** 1000 and 1200 mm widths.

Dimensions

1 door enclosure

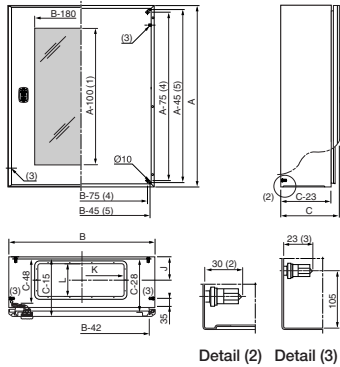

enclosure (mm)		cable gland plate				
width	depth	dimensions (mm)	no.	J	K	L
200-250	150-200	140 × 80	1	57	115	55
300-400	150	245 × 80	1	57	220	55
300	200	245 × 130	1	80	220	105
400	200-250	345 × 130	1	80	320	105
500	200-250	445 × 130	1	80	420	105
600	200-250	545 × 130	1	80	520	105
600	300-400	495 × 220	1	126	470	195
800	250-300-400	345 × 130	2	95	320	105
1000-1200	300-400	445 × 130	2	95	420	105

- (1) A-200 from height 800 mm.
- (2) 4 backstuds M8 × 25 mm.
- (3) 2 earthing studs M6 × 17.5 mm.
- (4) Stud centres.
- (5) Direct mounting fixing centres.

A: enclosure height
B: enclosure width
C: enclosure depth

2 doors enclosure

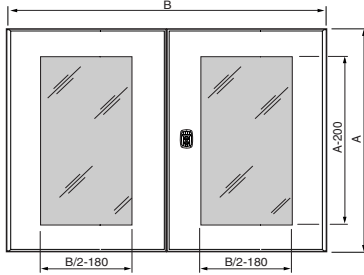

Door perforated rails (1)

enclosure (*) (mm)		door perforated rails (mm)				perforated rails on double door (mm)				perforated rails on internal door (mm)			
height	width	vertical		horizontal		vertical		horizontal		vertical		horizontal	
		F	D	E	C	F	D	E	C	F	D	E	C
400	300	320	237	-	-	-	-	-	-	-	-	-	-
400	400	320	337	-	-	-	-	-	-	-	-	-	-
400	600	320	537	-	-	-	-	-	-	-	-	-	-
500	300	370	237	-	-	-	-	-	-	-	-	-	-
500	400	370	337	-	-	-	-	-	-	-	-	-	-
500	500	370	437	-	-	-	-	-	-	-	-	-	-
600	400	370	337	-	-	-	-	-	-	-	-	-	-
600	500	370	437	-	-	-	-	-	-	-	-	-	-
600	600	370	537	-	-	-	-	-	-	-	-	-	-
600	800	370	737	-	-	-	-	-	-	-	-	-	-
800	600	570	537	-	-	-	-	-	-	-	-	-	-
800	800	570	737	620	749	-	-	-	-	-	-	-	-
800	1000	570	937	820	749	570	437	320	749	620	437	320	749
800	1200	-	-	-	-	570	537	420	749	620	537	420	749
1000	600	770	537	420	949	-	-	-	-	-	-	-	-
1000	800	770	737	620	949	-	-	-	-	-	-	-	-
1000	1000	770	937	820	949	770	437	320	949	820	437	320	949
1000	1200	-	-	-	-	770	537	420	949	820	537	420	949
1200	600	970	537	420	1149	-	-	-	-	-	-	-	-
1200	800	970	737	620	1149	-	-	-	-	-	-	-	-
1200	1000	970	937	820	1149	970	437	320	1149	1020	437	320	1149
1200	1200	-	-	-	-	970	537	420	1149	1020	537	420	1149
1400	1000	-	-	-	-	970	437	320	1349	1020	437	320	1349

(*) The doors of enclosures with dimensions less than 800 × 800 mm do not have horizontal wire guides.

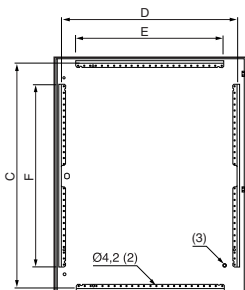

- (1) Glazed doors are fitted with one vertical scable guide only, on the hinge side.
- (2) 25 mm pitch.
- (3) 1 earthing stud M6 × 17.5 mm.

Universal enclosure and accessories selection guide

page 6

pages 37 to 40

Spacial 3D

mounting plate



dimensions			no. of doors	IP	RAL 7032 plain door		RAL 7032 glazed door	RAL 7035 plain door		Telequick mounting plate	galvanised plain mounting plate	symmetrical mixed mounting plate		micro-perforated mounting plate
H	W	D			without mounting plate	with mounting plate	without mounting plate	without mounting plate	with mounting plate			-	type	
300	200	150	1	66	83015	83315	-	87015	87315	55415	55715	-	-	50415
300	250	150	1	66	83001	83301	83501	-	-	55401	55701	55001	B	-
300	300	150	1	66	83002	83302	83502	-	87302	55402	55702	55002	B	50402
300	300	200	1	66	83003	83303	83503	87003	87303	55402	55702	55002	B	50402
300	400	150	1	66	83012	83312	83512	87012	87312	55412	55712	55012	B	50412
300	400	200	1	66	83004	83304	83504	-	-	55412	55712	55012	B	50412
400	300	150	1	66	83017	83317	83517	87017	87317	55417	55712	55017	B	50412
400	300	200	1	66	83018	83318	83518	87018	87318	55417	55712	55017	B	50412
400	400	200	1	66	83019	83319	83519	87019	87319	55419	55719	55019	B	50419
400	600	200	1	66	83031	83331	83531	87031	87331	55432	55726	55032	A	50426
400	600	250	1	66	83032	83332	83532	-	-	55432	55726	55032	A	50426
500	300	200	1	66	83021	83321	83521	-	-	55421	55721	55021	B	50421
500	400	200	1	66	83023	83323	83523	87023	87323	55423	55723	55023	B	50423
500	400	250	1	66	83024	83324	83524	87024	-	55423	55723	55023	B	50423
500	500	200	1	66	83022	83322	83522	87022	87322	55425	55725	55025	A	50425
500	500	250	1	66	83025	83325	83525	87025	87325	55425	55725	55025	A	50425
600	400	200	1	66	83026	83326	83526	87026	87326	55426	55726	55026	B	50426
600	400	250	1	66	83027	83327	83527	-	87327	55426	55726	55026	B	50426
600	500	250	1	66	83040	83340	83540	-	-	55428	55736	55027	B	-
600	600	200	1	66	83028	83328	83528	87028	87328	55429	55729	55029	A	50429
600	600	250	1	66	83029	83329	83529	87029	87329	55429	55729	55029	A	50429
600	600	300	1	66	83030	83330	83530	-	-	55429	55729	55029	A	50429
600	600	400	1	66	83039	83339	83539	-	-	55429	55729	55029	A	50429
600	800	300	1	66	83037	83337	83537	-	-	55431	55756	55031	A	50456
700	500	250	1	66	83035	83335	83535	87035	87335	55435	55735	55035	B	50435
800	600	200	1	66	83043	83343	83543	87043	87343	55456	55756	55056	A	50456
800	600	250	1	66	83056	83356	83556	87056	87356	55456	55756	55056	A	50456
800	600	300	1	66	83057	83357	83557	87057	87357	55456	55756	55056	A	50456
800	600	400	1	66	83044	83344	83544	-	-	55456	55756	55056	A	50456
800	800	250	1	66	83045	83345	83545	87045	87345	55446	55745	55045	A	50445
800	800	300	1	66	83046	83346	83546	87046	87346	55446	55745	55045	A	50445
800	1000	300	1	66	83047	83347	-	-	-	55447	55760	55047	A	50460
800	1000	300	2	55	83055	83355	-	-	-	55447	55760	55047	A	50460
800	1200	300	2	55	83048	83348	-	-	-	55457	55764	55061	A	50464
1000	600	250	1	66	83054	83354	83554	87054	87354	55454	55754	55054	A	50454
1000	600	300	1	66	83058	83358	83558	-	-	55454	55754	55054	A	50454
1000	600	400	1	66	83059	83359	83559	-	-	55454	55754	55054	A	50454
1000	800	250	1	66	83060	83360	83560	-	87360	55460	55760	55060	A	50460
1000	800	300	1	66	83061	83361	83561	87061	87361	55460	55760	55060	A	50460
1000	800	400	1	66	83062	83362	83562	-	-	55460	55760	55060	A	50460
1000	1000	300	1	66	83070	83370	83570	87070	87370	55463	55763	55063	A	50463
1000	1000	300	2	55	83063	83363	83563	-	87363	55463	55763	55063	A	50463
1000	1200	300	2	55	83066	83366	-	-	-	55461	55765	55061	A	50465
1000	1200	400	2	55	83072	83372	-	-	-	55461	55765	55061	A	50465
1200	600	300	1	66	83073	83373	83573	-	-	55430	55730	-	-	50430
1200	600	400	1	66	83074	83374	83574	-	-	55430	55730	-	-	50430
1200	800	300	1	66	83064	83364	83564	87064	87364	55464	55764	55064	A	50464
1200	800	400	1	66	83067	83367	83567	-	-	55464	55764	55064	A	50464
1200	1000	300	1	66	83071	83371	83571	87071	-	55465	55765	55065	A	50465
1200	1000	300	2	55	83065	83365	83565	87065	87365	55465	55765	55065	A	50465
1200	1000	400	2	55	83075	83375	-	-	-	55465	55765	55065	A	50465
1200	1200	300	2	55	83076	83376	-	-	-	55469*	55709	-	-	-
1200	1200	400	2	55	83077	83377	-	-	-	55469*	55709	-	-	-
1400	1000	300	2	55	83078	83378	-	-	-	55470	55770	-	-	-

* 2 part mounting plate. For depth adjustment, see page 44.

Universal enclosure and accessories selection guide (continued)

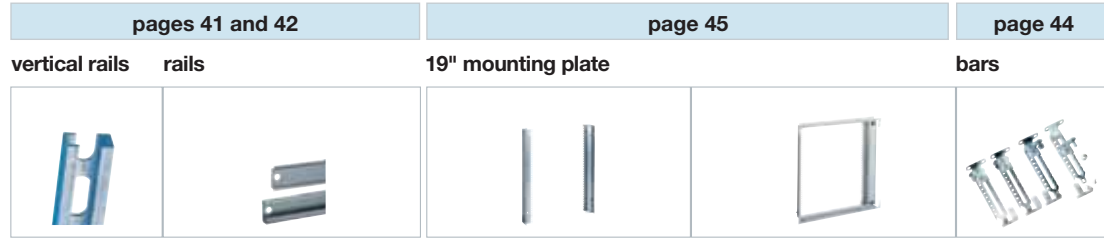

dimensions			no. of doors	IP	aluminium vertical rails	symmetrical rail	type	19" mounting plate				step slides
H	W	D						fixed	no. of units	pivoting	no. of units	
300	200	150	1	66	51101	-	-	-	-	-	-	-
300	250	150	1	66	51101	-	-	-	-	-	-	-
300	300	150	1	66	51101	51011	B	-	-	-	-	-
300	300	200	1	66	51101	51011	B	-	-	-	-	51720
300	400	150	1	66	51101	51012	B	-	-	-	-	-
300	400	200	1	66	51101	51012	B	-	-	-	-	51720
400	300	150	1	66	51102	51011	B	-	-	-	-	-
400	300	200	1	66	51102	51011	B	-	-	-	-	51720
400	400	200	1	66	51102	51012	B	-	-	-	-	51720
400	600	200	1	66	51102	51014	B	-	-	-	-	51720
400	600	250	1	66	51102	51014	B	25911	8	25940	7	51725
500	300	200	1	66	51103	51011	B	-	-	-	-	51720
500	400	200	1	66	51103	51012	B	-	-	-	-	51720
500	400	250	1	66	51103	51012	B	-	-	-	-	51725
500	500	200	1	66	51103	51013	A	-	-	-	-	51720
500	500	250	1	66	51103	51013	A	-	-	-	-	51725
600	400	200	1	66	51104	51012	B	-	-	-	-	51720
600	400	250	1	66	51104	51012	B	-	-	-	-	51725
600	500	250	1	66	51104	51013	B	-	-	-	-	51725
600	600	200	1	66	51104	51014	A	25912	12	25941	11	51720
600	600	250	1	66	51104	51014	A	25912	12	25941	-	51725
600	600	300	1	66	51104	51014	A	25912	12	25941	-	51730
600	600	400	1	66	51104	51014	A	25912	12	25941	-	51740
600	800	300	1	66	51104	51015	A	-	-	-	-	51730
700	500	250	1	66	51105	51013	A	-	-	-	-	51725
800	600	200	1	66	51106	51014	A	25913	17	25942	16	51720
800	600	250	1	66	51106	51014	A	25913	17	25942	16	51725
800	600	300	1	66	51106	51014	A	25913	17	25942	16	51730
800	600	400	1	66	51106	51014	A	25913	17	25942	16	51740
800	800	250	1	66	51106	51015	A	-	-	-	-	51725
800	800	300	1	66	51106	51015	A	-	-	-	-	51730
800	1000	300	1	66	51106	51016	A	-	-	-	-	51730
800	1000	300	2	55	51106	51016	A	-	-	-	-	51730
800	1200	300	2	55	51106	51014 (1)	A	-	-	-	-	51730
1000	600	250	1	66	51107	51014	A	25914	21	25943	20	51725
1000	600	300	1	66	51107	51014	A	25914	21	25943	20	51725
1000	600	400	1	66	51107	51014	A	25914	21	25943	20	51740
1000	800	250	1	66	51107	51015	A	-	-	25944	20	51725
1000	800	300	1	66	51107	51015	A	-	-	25944	20	51730
1000	800	400	1	66	51107	51015	A	-	-	25944	20	51740
1000	1000	300	1	66	51107	51016	A	-	-	-	-	51730
1000	1000	300	2	55	51107	51016	A	-	-	-	-	51730
1000	1200	300	2	55	51107	51014 (1)	A	-	-	-	-	51730
1000	1200	400	2	55	51107	51014 (1)	A	-	-	-	-	51730
1200	600	300	1	66	51108 (4)	51014	A	-	-	-	-	51740
1200	600	400	1	66	51108 (4)	51014	A	-	-	-	-	51740
1200	800	300	1	66	51108 (4)	51015	A	-	-	25945	25	51730
1200	800	400	1	66	51108 (4)	51015	A	-	-	25945	25	51740
1200	1000	300	1	66	51108 (4)	51016	A	-	-	-	-	51730
1200	1000	300	2	55	51108 (4)	51016	A	-	-	-	-	51730
1200	1000	400	2	55	51108 (4)	51016	A	-	-	-	-	51740
1200	1200	300	2	55	51108 (4)	51014 (1)	A	-	-	-	-	51730
1200	1200	400	2	55	51108 (4)	51014 (1)	A	-	-	-	-	51740
1400	1000	300	2	55	-	51108	A	-	-	-	-	51730

(1) Order two 600 mm cross bars
(4) Steel vertical rail.

Universal enclosure and accessories selection guide (continued)



dimensions			no. of doors	IP	cut-out front plate	no. of modules	plain front plate	plain mounting plate	internal door (***)	door cross bars
H	W	D								
300	200	150	1	66	-	-	-	-	-	-
300	250	150	1	66	-	-	-	-	-	-
300	300	150	1	66	-	-	-	-	-	-
300	300	200	1	66	-	-	-	-	-	-
300	400	150	1	66	-	-	-	-	-	-
300	400	200	1	66	-	-	-	-	-	-
400	300	150	1	66	80450	24	80430	80440	55617	-
400	300	200	1	66	80450	24	80430	80440	55617	-
400	400	200	1	66	-	-	-	-	-	51741
400	600	200	1	66	-	-	-	-	-	51743
400	600	250	1	66	-	-	-	-	-	51743
500	300	200	1	66	-	-	-	-	-	-
500	400	200	1	66	80451	48	80431	80441	55620	51741
500	400	250	1	66	80451	48	80431	80441	55620	51741
500	500	200	1	66	-	-	-	-	-	51742
500	500	250	1	66	-	-	-	-	-	51742
600	400	200	1	66	80452	48	80431	80441	55626	51741
600	400	250	1	66	80452	48	80431	80441	55626	51741
600	500	250	1	66	-	-	-	-	-	-
600	600	200	1	66	80453	84	-	-	-	51743
600	600	250	1	66	80453	84	-	-	-	51743
600	600	300	1	66	80453	84	-	-	-	51743
600	600	400	1	66	80453	84	-	-	-	51743
600	800	300	1	66	-	-	-	-	-	51744
700	500	250	1	66	80454	66	80432	80442	55634	51742
800	600	200	1	66	80456	84*	80433	80443	55656	51743
800	600	250	1	66	80457	112*	80433	80443	55656	51743
800	600	300	1	66	80457	112*	80433	80443	55656	51743
800	600	400	1	66	80457	112*	80433	80443	55656	51743
800	800	250	1	66	-	-	-	-	-	51744
800	800	300	1	66	-	-	-	-	-	51744
800	1000	300	1	66	-	-	-	-	-	51745
800	1000	300	2	55	-	-	-	-	-	-
800	1200	300	2	55	-	-	-	-	-	-
1000	600	250	1	66	80458	168**	-	-	55654	51743
1000	600	300	1	66	80458	168**	-	-	55654	51743
1000	600	400	1	66	80458	168**	-	-	55654	51743
1000	800	250	1	66	80459	240	80434	80444	55660	51744
1000	800	300	1	66	80459	240	80434	80444	55660	51744
1000	800	400	1	66	80459	240	80434	80444	55660	51744
1000	1000	300	1	66	-	-	-	-	-	51745
1000	1000	300	2	55	-	-	-	-	-	-
1000	1200	300	2	55	-	-	-	-	-	-
1000	1200	400	2	55	-	-	-	-	-	-
1200	600	300	1	66	-	-	-	-	55665	-
1200	600	400	1	66	-	-	-	-	55665	-
1200	800	300	1	66	-	-	-	-	55664	51744
1200	800	400	1	66	-	-	-	-	55664	51744
1200	1000	300	1	66	-	-	-	-	-	51745
1200	1000	300	2	55	-	-	-	-	-	-
1200	1000	400	2	55	-	-	-	-	-	-
1200	1200	300	2	55	-	-	-	-	-	-
1200	1200	400	2	55	-	-	-	-	-	-
1400	1000	300	2	55	-	-	-	-	-	-

(*) Possible to mount ref. 80456 or 80457.

(**) Possible to mount ref. 80458 or 80459.

(**) To mount the internal door and adjust its depth, it is necessary to order the corresponding step slides.

Universal enclosure and accessories selection guide (continuation and end)



dimensions			no. of doors	IP	cable gland plates				plinth		post fixing	wall fixing brackets for heavy loads	canopy
H	W	D			steel	with knock outs	aluminium	with membranes	100 mm	200 mm			
300	200	150	1	66	51531	51541	51551	-	-	-	-	83100	
300	250	150	1	66	51531	51541	51551	-	-	-	-	83099	
300	300	150	1	66	51532	51542	51552	-	-	80950	-	83101	
300	300	200	1	66	51533	51543	51553	51563	-	80950	-	83102	
300	400	150	1	66	51532	51542	51552	-	-	80951	-	83103	
300	400	200	1	66	51534	51544	51554	51564	-	80951	-	83104	
400	300	150	1	66	51532	51542	51552	-	-	80950	-	83101	
400	300	200	1	66	51533	51543	51553	51563	-	80950	-	83102	
400	400	200	1	66	51534	51544	51554	51564	-	80951	-	83104	
400	600	200	1	66	51536	51546	51556	51566	-	80953	51196	83108	
400	600	250	1	66	51536	51546	51556	51566	-	80953	51196	83109	
500	300	200	1	66	51533	51543	51553	51563	-	80950	-	83102	
500	400	200	1	66	51534	51544	51554	51564	-	80951	-	83104	
500	400	250	1	66	51534	51544	51554	51564	-	80951	-	83105	
500	500	200	1	66	51535	51545	51555	51565	-	80952	-	83106	
500	500	250	1	66	51535	51545	51555	51565	-	80952	-	83107	
600	400	200	1	66	51534	51544	51554	51564	-	80951	-	83104	
600	400	250	1	66	51534	51544	51554	51564	-	80951	-	83105	
600	500	250	1	66	51535	51545	51555	51565	-	80953	-	83107	
600	600	200	1	66	51536	51546	51556	51566	-	80953	51196	83108	
600	600	250	1	66	51536	51546	51556	51566	-	80953	51196	83109	
600	600	300	1	66	51537	51547	51557	51567	69063	69263	80953	51196	83110
600	600	400	1	66	51537	51547	51557	51567	69064	69264	80953	51196	83111
600	800	300	1	66	51534*	51544*	51554*	51564*	69083	69283	80954	51197	83113
700	500	250	1	66	51535	51545	51555	51565	-	-	80953	-	83107
800	600	200	1	66	51536	51546	51556	51566	-	-	80953	51196	83108
800	600	250	1	66	51536	51546	51556	51566	-	-	80953	51196	83109
800	600	300	1	66	51537	51547	51557	51567	69063	69263	80953	51196	83110
800	600	400	1	66	51537	51547	51557	51567	69064	69264	80953	51196	83111
800	800	250	1	66	51534*	51544*	51554*	51564*	-	-	80954	51197	83112
800	800	300	1	66	51534*	51544*	51554*	51564*	69083	69283	80954	51197	83113
800	1000	300	1	66	51535*	51545*	51555*	51565*	69103	69303	-	51198	83115
800	1000	300	2	55	51535*	51545*	51555*	51565*	69103	69303	-	51198	83115
800	1200	300	2	55	51535*	51545*	51555*	51565*	69123	69323	-	51199	83116
1000	600	250	1	66	51536	51546	51556	51566	-	-	-	51196	83110
1000	600	300	1	66	51536	51546	51556	51566	69063	69263	-	51199	83109
1000	600	400	1	66	51537	51547	51557	51567	69064	69264	-	51196	83111
1000	800	250	1	66	51534*	51544*	51554*	51564*	-	-	-	51197	83112
1000	800	300	1	66	51534*	51544*	51554*	51564*	69083	69283	-	51197	83113
1000	800	400	1	66	51534*	51544*	51554*	51564*	69084	69284	-	51197	83114
1000	1000	300	1	66	51535*	51545*	51555*	51565	69103	69303	-	51198	83115
1000	1000	300	2	55	51535*	51545*	51555*	51565	69103	69303	-	51198	83115
1000	1200	300	2	55	51535*	51545*	51555*	51565	69123	69323	-	51199	83116
1000	1200	400	2	55	51535*	51545*	51555*	51565	69124	69324	-	51199	83117
1200	600	300	1	66	51537	51547	51557	51567	69063	69263	-	51196	83110
1200	600	400	1	66	51537	51547	51557	51567	69064	69264	-	51196	83111
1200	800	300	1	66	51534*	51544*	51554*	51564*	69083	69283	-	51197	83113
1200	800	400	1	66	51534*	51544*	51554*	51564*	69084	69284	-	51197	83114
1200	1000	300	1	66	51535*	51545*	51555*	51565	69103	69303	-	51198	83115
1200	1000	300	2	55	51535*	51545*	51555*	51565	69103	69303	-	51198	83115
1200	1000	400	2	55	51535*	51545*	51555*	51565	69104	69304	-	51198	83118
1200	1200	300	2	55	51535*	51545*	51555*	51565	69123	69323	-	51199	83116
1200	1200	400	2	55	51535*	51545*	51555*	51565	69124	69324	-	51199	83117
1400	1000	300	2	55	51535*	51545*	51555*	51565	69103	69303	-	51198	83115

(* 2 plates.

Accessories

Composition accessories



page 14

fixing brackets	
steel	51206
stainless steel	51207



page 16

2 lifting eyebolts	
	51229

Door accessories



page 30

door retainer	
	51210



page 30

hinges	
standard	51209
180°	51208



page 30

door retainer	
	51231



page 31

diagram pocket	
A4 P22	21322
A4 P40	21323
A3 P35	21317

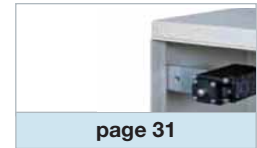

page 31

door contact	
	51341



page 29

handle with key	
1242 E	51332
405	51333
421	51334
455	51335



page 29

inserts	
6 mm square	51325
6 mm square	51326
5 mm double bar	51329
CNOMO 6.5 mm triangle	51330

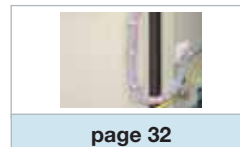

page 32

tube for cable entry	
	51595

Other accessories



page 42

slides	
90 mm	21081
130 mm	21082



page 42

support brackets	
	21036



page 97

19" hardware	
screw-nut	11916



page 27

2 fixing brackets of the earthing collector bar	
	51237



page 52

paint touch-up pen paint	
RAL 7032	21235
RAL 7035	21236



page 51

lamps	
France - UTE (16 A socket)	21415
Germany - VDE	21416
UK - BS (British Standard)	21417
voltage 115 V	21465
Switzerland - CH	21466

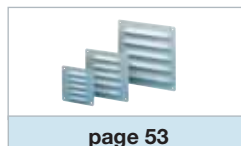

page 53

metallic ventilation louvres	
120 × 120 mm	21407
160 × 160 mm	21410
220 × 200 mm	21418